

1-100

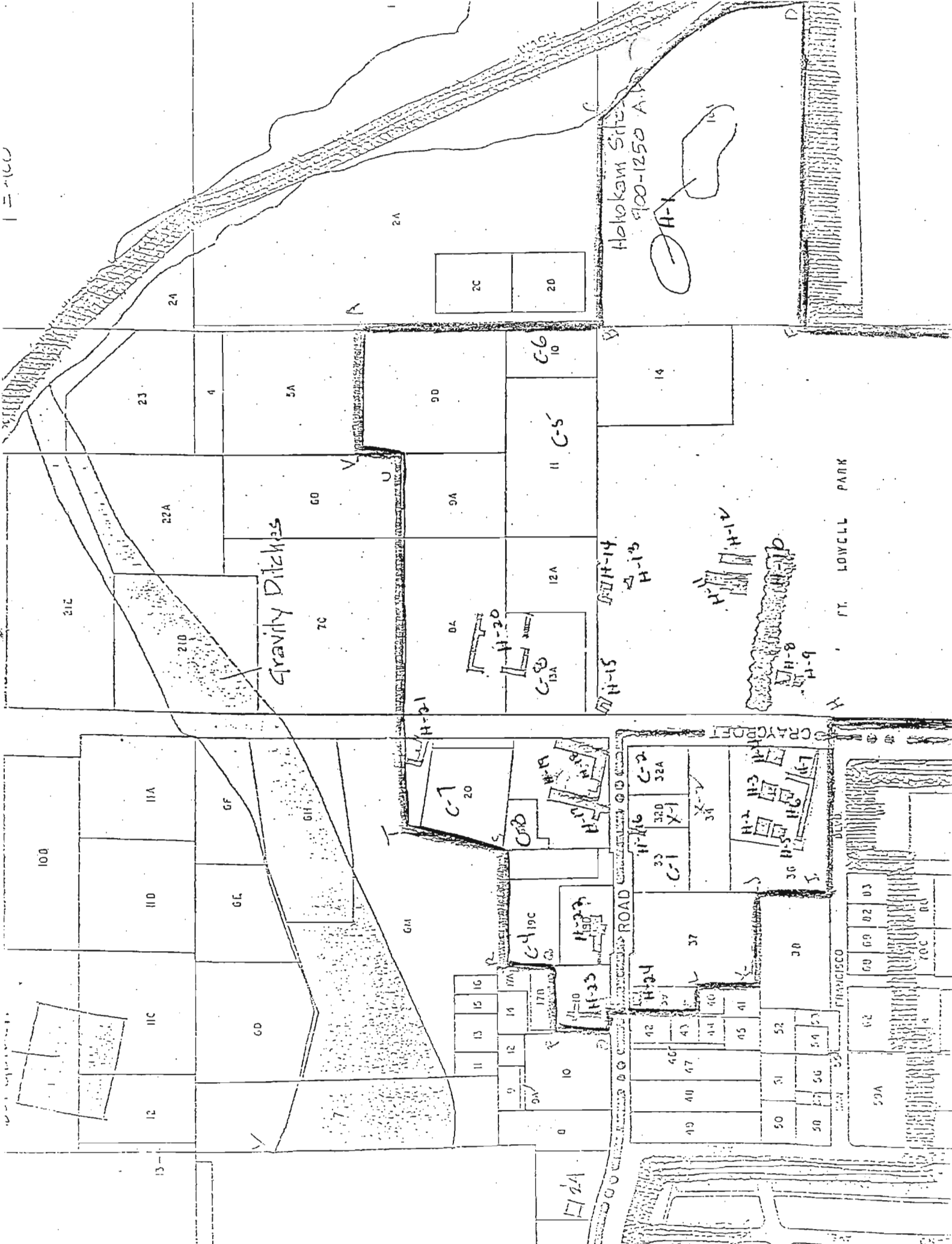

GRAVITY DITCHES

HOKOKAMI SITE
100-1250 A-1

FRANCISCO
DEVON

LOWELL PARK

H-1

H-20
C-13A

H-14
H-15
H-16
H-17
H-18
H-19

H-12
H-8
H-9

100

11A

11B

11C

12

13

14

15

16

17A

17B

18

19

20

21

22

23

24

25

26

27

28

29

30

31

32

33

34

35

36

37

38

39

40

41

42

43

44

45

46

47

48

49

50

51

52

53

54

55

56

57

58

59

60

61

62

63

64

65

66

67

68

69

70

71

72

73

74

75

76

77

78

79

80

81

82

83

84

85

86

87

88

89

90

91

92

93

94

95

96

97

98

99

100

101

102

103

104

105

106

107

108

109

110

111

112

113

114

115

116

117

118

119

120

121

122

123

124

125

126

127

128

129

130

131

132

133

134

135

136

137

138

139

140

141

142

143

144

145

146

147

148

149

150

151

152

153

154

155

156

157

158

159

160

161

162

163

164

165

166

167

168

169

170

171

172

173

174

175

176

177

178

179

180

181

182

183

184

185

186

187

188

189

190

191

192

193

194

195

196

197

198

199

200

201

202

203

204

205

206

207

208

209

210

211

212

213

214

215

216

217

218

219

220

221

222

223

224

225

226

227

228

229

230

231

232

233

234

235

236

237

238

239

240

241

242

243

244

245

246

247

248

249

250

251

252

253

254

255

256

257

258

259

260

261

262

263

264

265

266

267

268

269

270

271

272

273

274

275

276

277

278

279

280

281

282

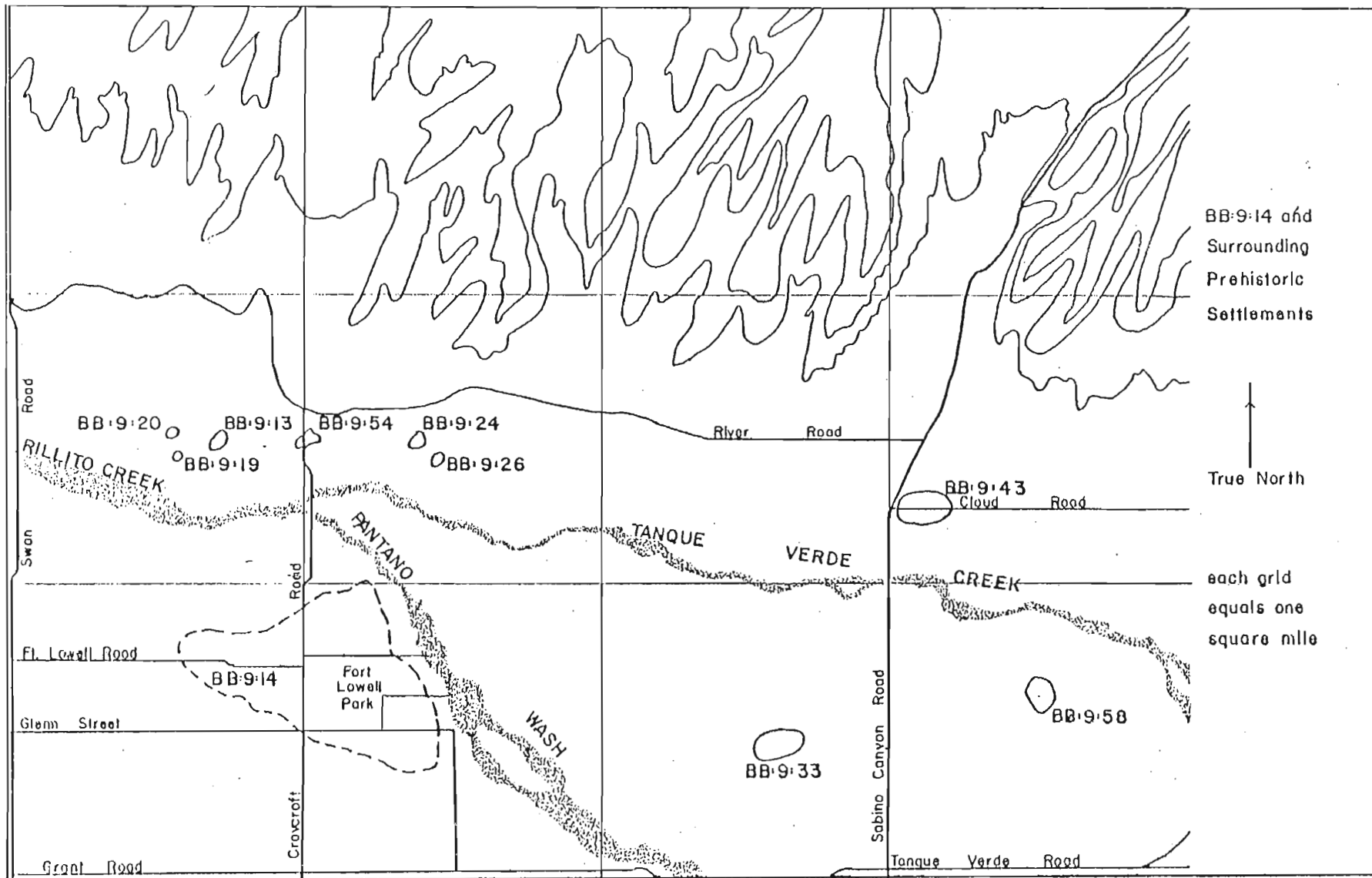

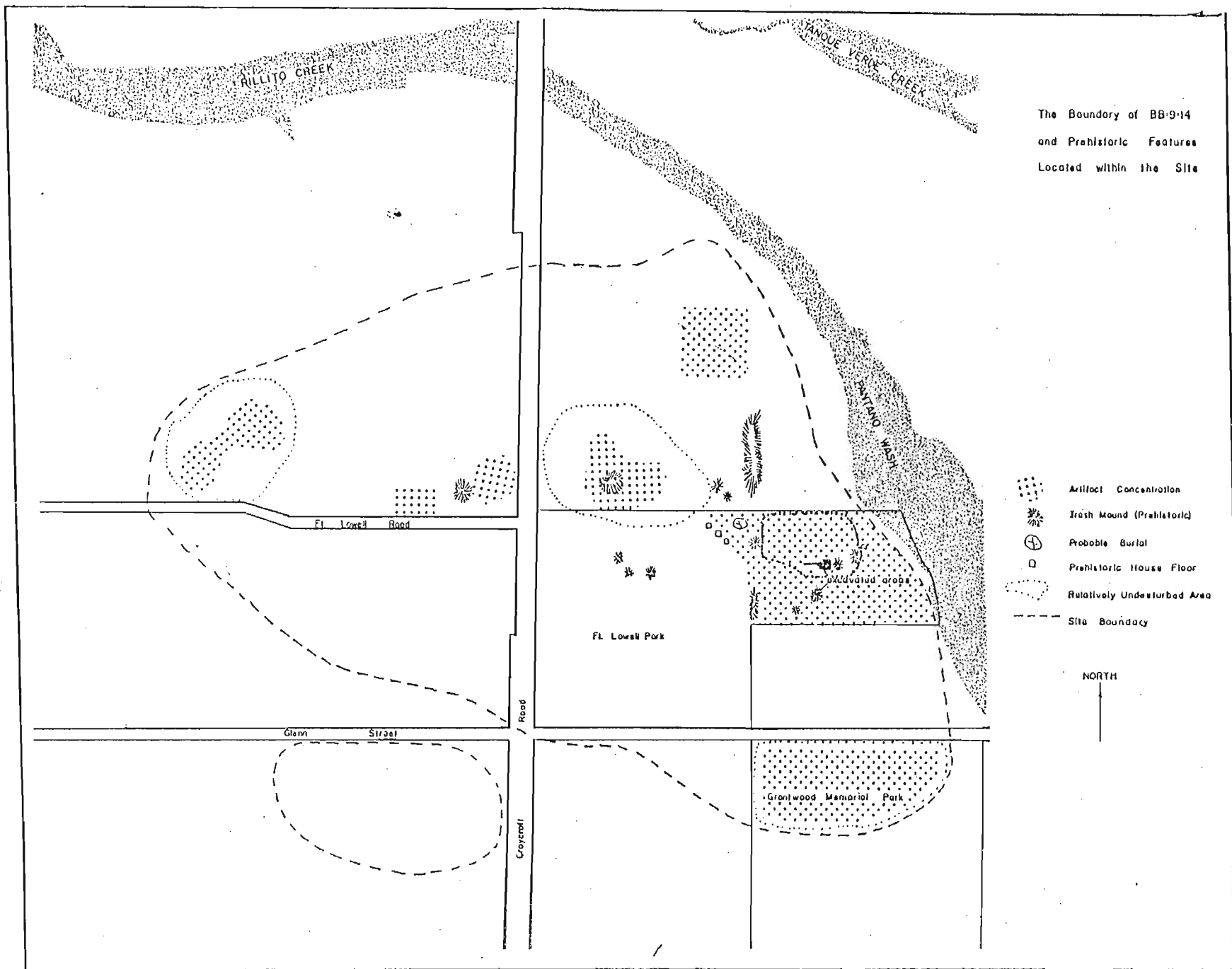

A P DOLSIUS
MAN DOLSIUS
CHAS DOLSIUS
435A

A B. EARHART
3159A

MABEL FRANCIS
40A

FORT LOW ROAD

R C MAGOR
101A

W EY ADKINS
682A

DOLLIE CATE
2016A

DESERT SAN ORIUM

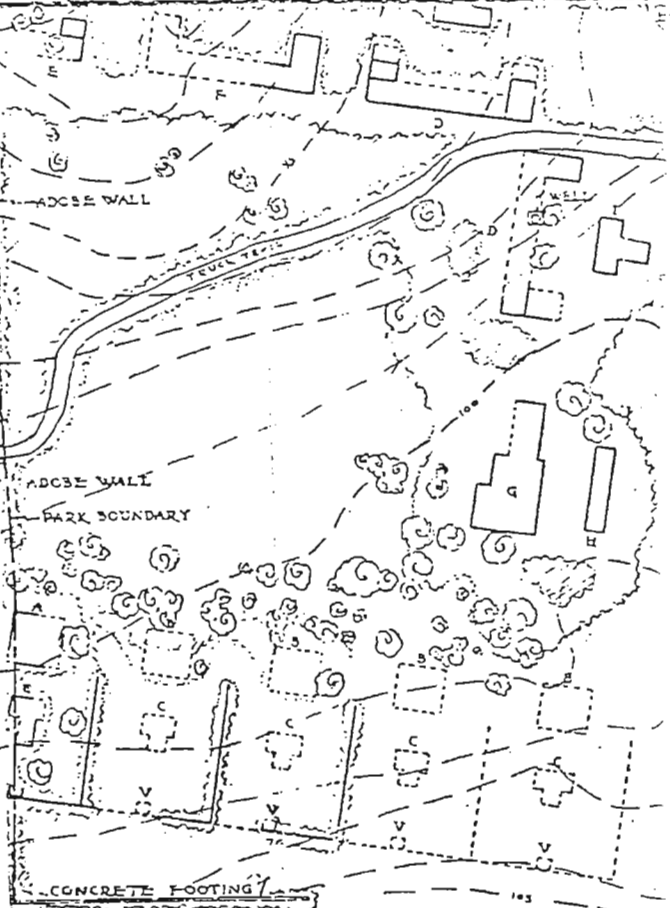
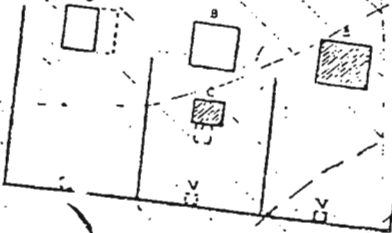
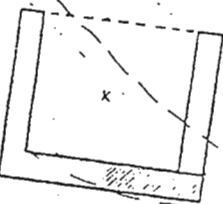

CRAYCROFT ROAD

DIVERSION DITCH

BARBED WIRE
PARK B

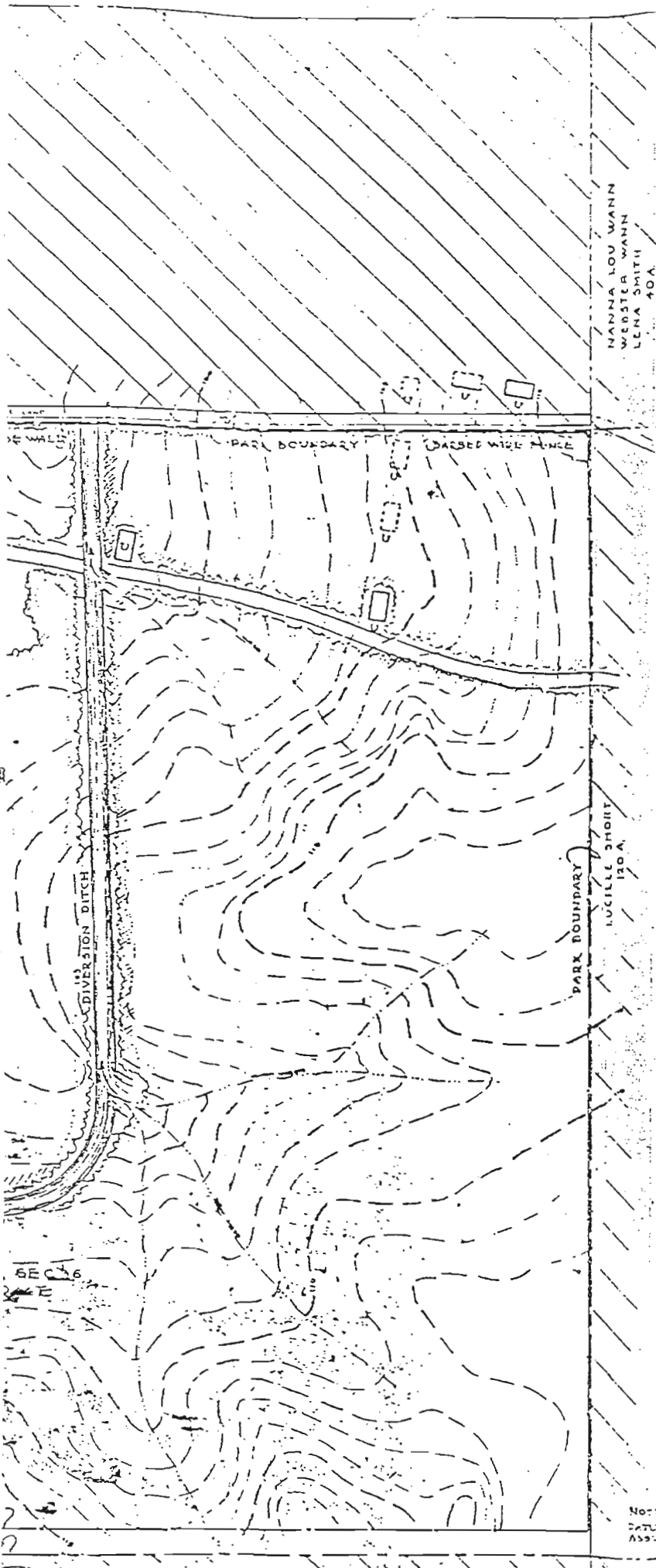

NANNA LOU WANN
WEBSTER WANN
LENA SMITH
40A

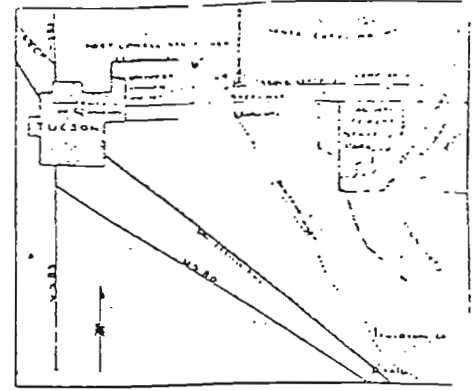

KEY MAP

Figure 7

LEGEND

- PARK BOUNDARY
- MAJOR ROADS-20'
- MINOR ROADS-10-12'
- FORT BUILDINGS:
 - INTACT, OCCUPIED
 - WALLS STANDING
 - WALLS FALLEN
- MAJOR TREE GROWTH: MESQUITE - D-6-12
- SHRUB MASSES: CREOSOTE BUSH, CATCLAW
- LAND STATUS:
 - STATE LAND
 - PRIVATE LAND
- FENCE
 - ADOBE WALL

- IDENTITY OF FORT BUILDINGS:
- A - COMMANDING OFFICER'S QUARTERS
 - B - OFFICERS QUARTERS
 - C - KITCHENS
 - D - INFANTRY COMPANY QUARTERS
 - E - CAVALRY BAND QUARTERS
 - F - COMPANY QUARTERS
 - G - HOSPITAL
 - H - KITCHENS
 - I - COMPANY
 - X - Q.M. & COMMISSARY STOREHOUSES
 - L - ADJUTANT'S OFFICE
 - M - BAKHOUSE
 - N - GUARDHOUSE
 - O - Q.M. & COMPANY OFFICES
 - U - POST TRADER'S STORE
 - R - Q.M. CORRAL
 - S - CAVALRY CORRAL
 - T - TELEGRAPH OFFICE
 - U - LAUNDRESSES QUARTERS
 - V - DRIVES

U.S. DEPT. OF THE INTERIOR
NATIONAL PARK SERVICE
AN
UNIVERSITY OF ARIZONA COOPERATING
BRANCH OF RECREATIONAL DIAGNOSIS STATE LOCAL PARK

STATE PARK AUTHORITY
TUCSON, ARIZONA
OWNED AREA

INSPECTOR
M. J. R. C.
DESIGNED BY
JUN 6, 1937

BASE MAP

NOTE DATUM ELEVATION ASSUMED

Ft. Lowell UTM References

- A 12/512190/3569490
- B 12/512190/3569240
- C 12/512420/3569240
- D 12/512560/3569040
- E 12/512190/3569020

- F 12/512200/3568850
- G 12/511830/3568850
- U 12/512000/3569450
- V 12/512000/3569490

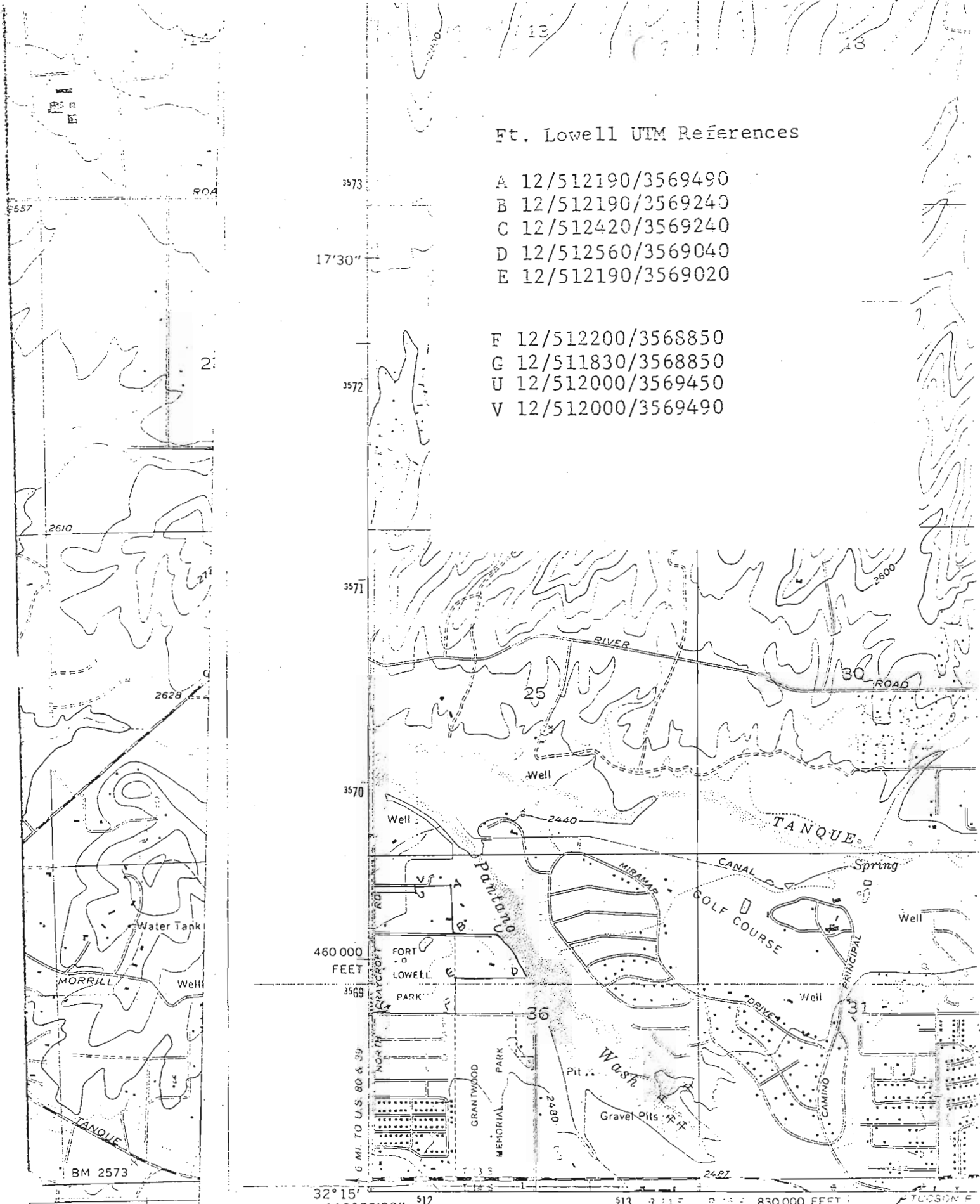

32° 15' 110° 52' 30" 113 830 000 FEET TUCSON E

TUCSON
3848 III NW

Mapped, edited, and published by the Geological Survey
 Control by USGS and USC&GS
 Topography from aerial photographs by photogrammetric methods
 and by planetable surveys 1957. Aerial photographs taken 1954
 Polyconic projection. 1927 North American datum
 10 000 feet grid based on datum

Ft. Lowell UTM References

- H 12/511800/3569000
- I 12/511650/3569000
- J 12/511650/3569800
- K 12/511600/3569800
- L 12/511600/3569140
- M 12/511560/3569140
- N 12/511560/3569220
- O 12/511540/3569220
- P 12/511540/3569280
- Q 12/511590/3569280
- R 12/511590/3569330
- S 12/511690/3569330
- T 12/511720/3569420

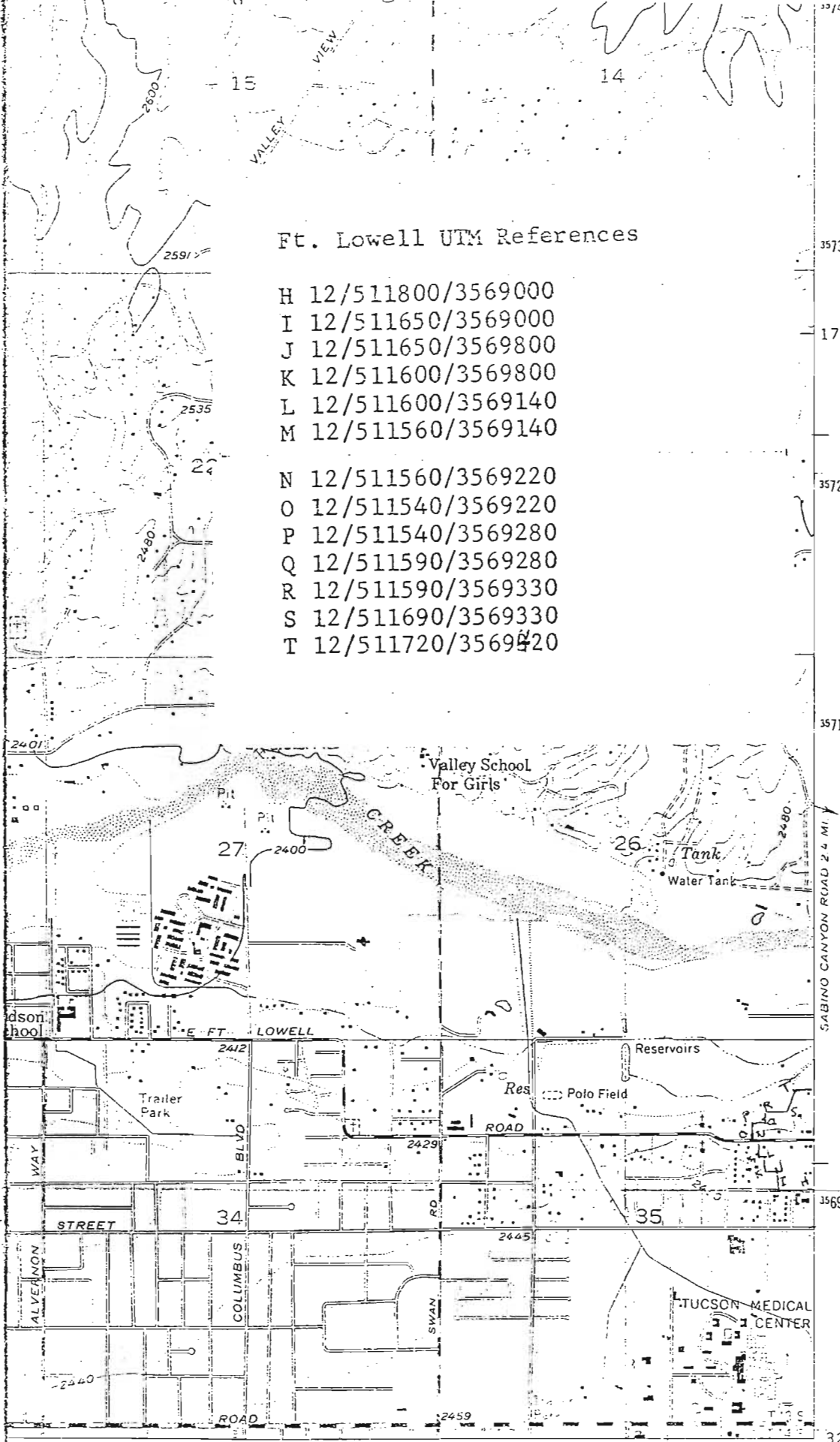

INTERIOR-GEOLOGICAL SURVEY WASHINGTON D.C. 20541
511000m E. 3569000m N.

ROAD CLASSIFICATION

- Heavy-duty
- Medium-duty
- Light-duty
- Unimproved dirt

TUCSON EAST
3818 111 NE

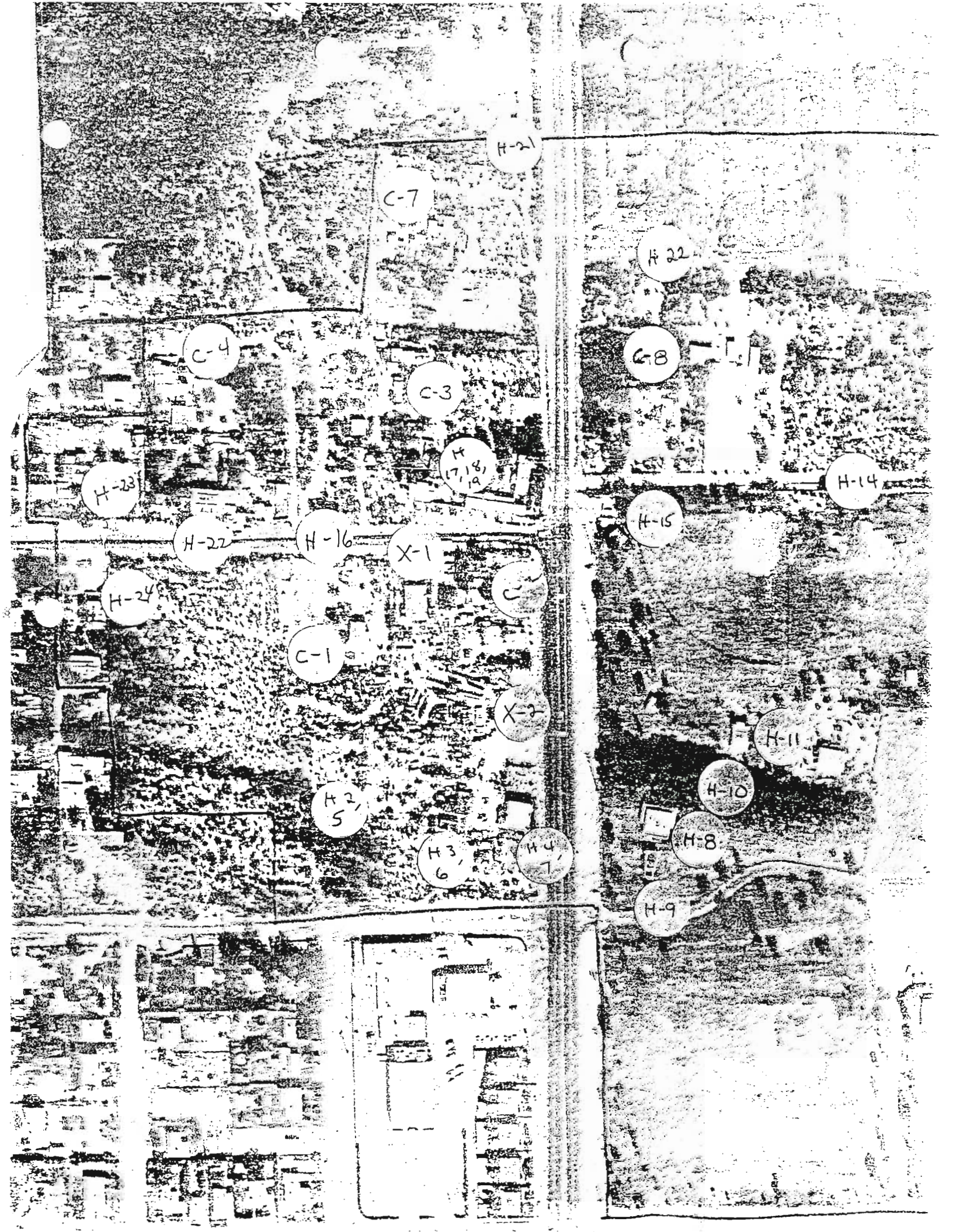

F-21

C-7

F-22

C-4

G-8

C-3

H
17, 18,
19

H-23

H-14

H-22

H-16

X-1

H-15

H-24

C-1

X-2

H-11

H-2,
5

H-10

H-3,
6

H-4,
7

H-8

H-9

C-5

C-6

H-1

